

SFS-CAT

SAE-Flanscbundarmatur, Spezialausführung für Caterpillar / 9000 PSI

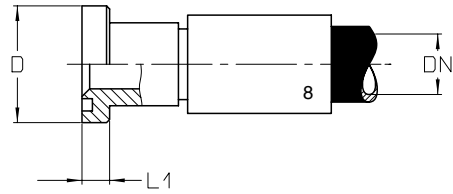

RD - Pressarmatur ³

Bestell-Nr.	DN	Kenngrösse	D	L1
1425 - 20	20	3/4"	41,3	14
1425 - 20 / 25	20	1"	47,6	14
1425 - 25	25	1"	47,6	14
1425 - 25 / 32	25	1 1/4"	54	14
1425 - 32	32	1 1/4"	54	14

SFS-CAT 90°

SAE-Flanscbundarmatur, Spezialausführung für Caterpillar / 9000 PSI

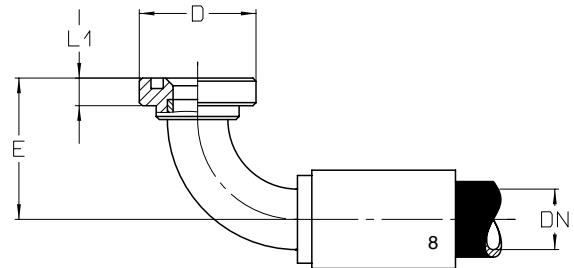

RD - Pressarmatur ³

Bestell-Nr.	DN	Kenngrösse	D	L1	E
1425 - 20 - 90	20	3/4"	41,3	14	66
1425 - 20 / 25 - 90	20	1"	47,6	14	71
1425 - 25 - 90	25	1"	47,6	14	79
1425 - 25 / 32 - 90	25	1 1/4"	54	14	77
1425 - 32 - 90	32	1 1/4"	54	14	100

SFS-CAT 45°

SAE-Flanschbundarmatur, Spezialausführung für Caterpillar / 9000 PSI

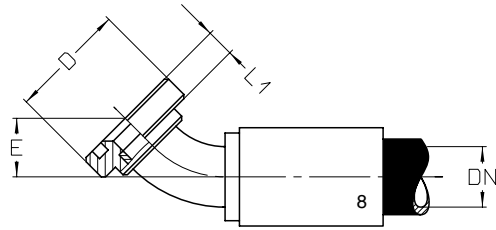

RD - Pressarmatur ³

Bestell-Nr.	DN	Kenngrösse	D	L1	E
1425 - 20 - 45	20	3/4"	41,3	14	36
1425 - 20 / 25 - 45	20	1"	47,6	14	41
1425 - 25 - 45	25	1"	47,6	14	45
1425 - 25 / 32 - 45	25	1 1/4"	54	14	45
1425 - 32 - 45	32	1 1/4"	54	14	

SFS-CAT 30°

SAE-Flanschbundarmatur, Spezialausführung für Caterpillar / 9000 PSI

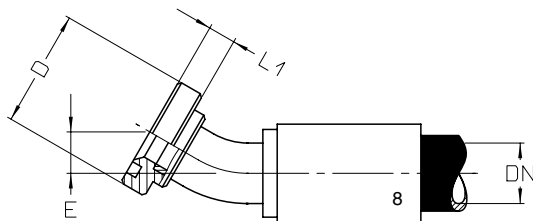

RD - Pressarmatur ³

Bestell-Nr.	DN	Kenngrösse	D	L1	E
1425 - 20 - 30	20	3/4"	41,3	14	29
1425 - 20 / 25 - 30	20	1"	47,6	14	30
1425 - 25 - 30	25	1"	47,6	14	32
1425 - 25 / 32 - 30	25	1 1/4"	54	14	32